

Download & Sign up



DeltaSolar
DELTA ELECTRONICS, INC.



NOTICE

Before setting up, please login once in an internet-connected environment.

1. Click "Create account".
2. Fill in your email address and password, click the check box and click "REGISTRATION".

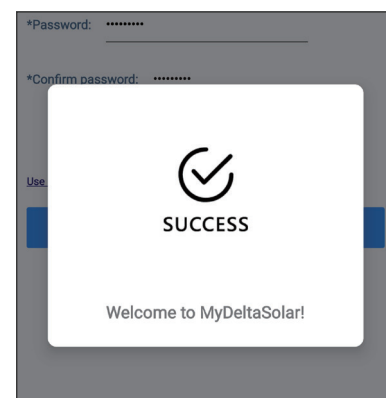
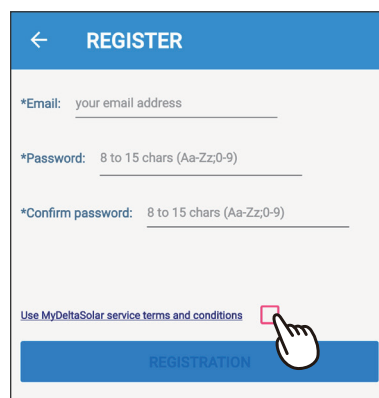
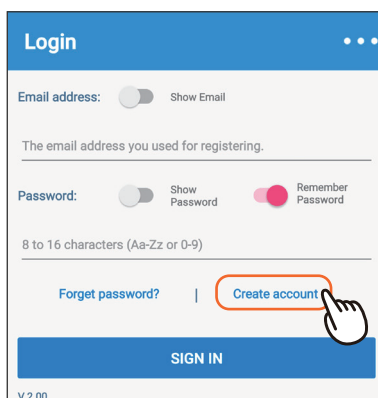

Commission

1. Click "Create new plant/device"

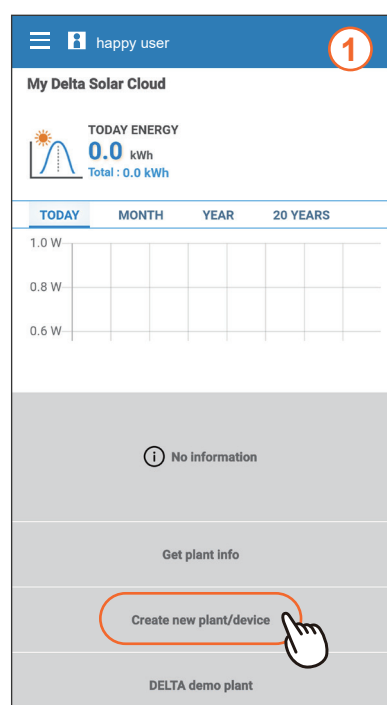

2. Select the target device and click "SET"

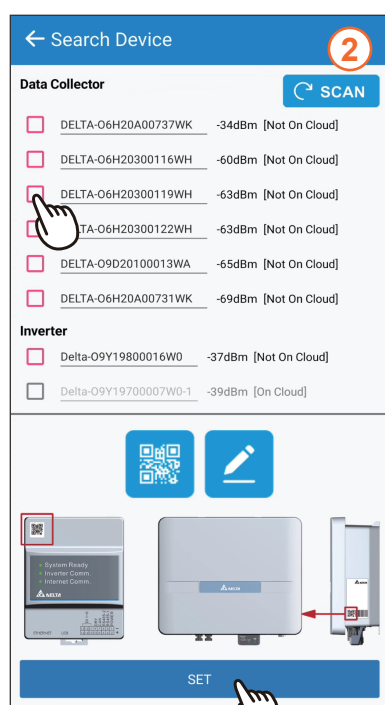

- 3-Inv. Click "Auto" to assign the ID automatically, and click "SET"
- 3-DC1. Select the target inverters, click "Auto ID" to assign the ID automatically, and click "SET".

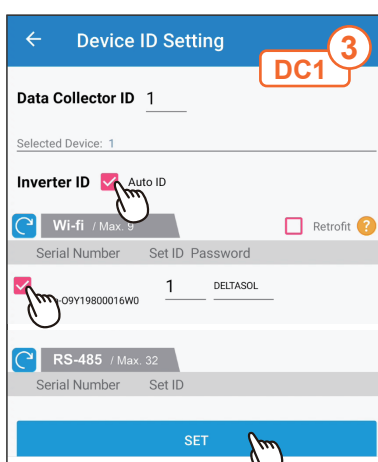
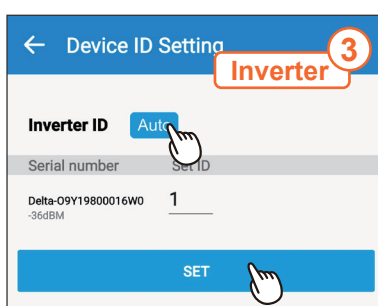

4. Select grid code and click "SET"
5. Click "NEXT"

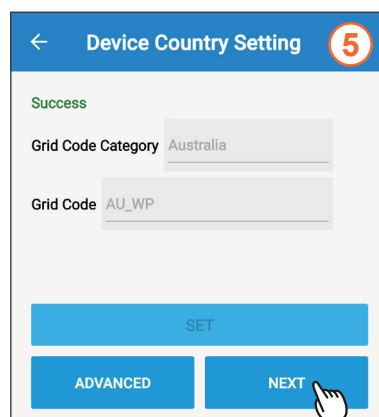
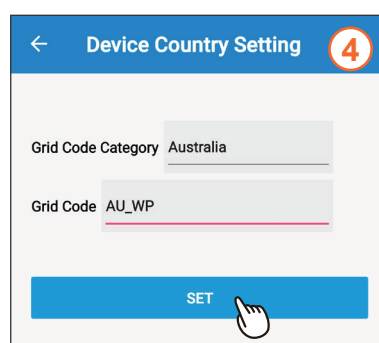

6. Set a new password to the device and click "SET"
7. Click "Connect to the Cloud" to use MyDeltaSolar monitoring or click "Skip" to go to step 9

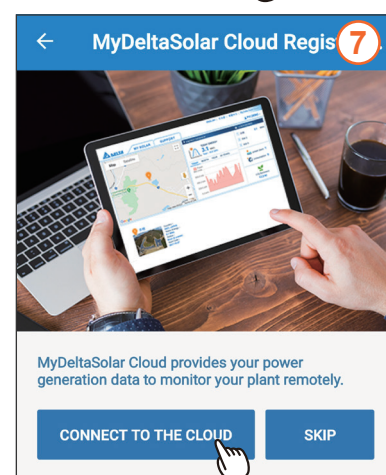
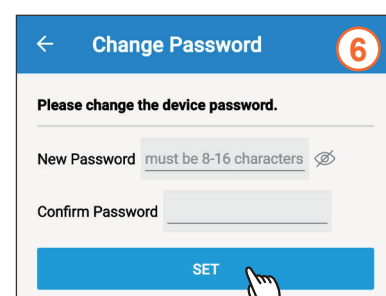

8. Select the network interface and click "SET".

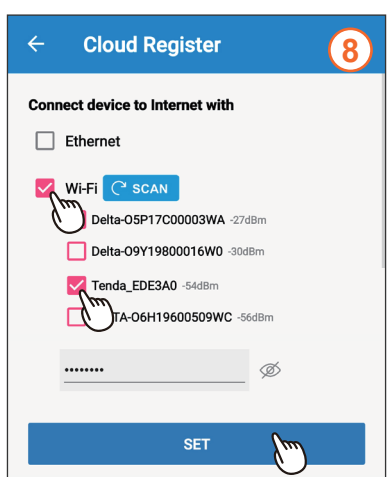

9. Select the plant type and then assign a plant name. Click "Get Location" for the GPS position and click "SET".

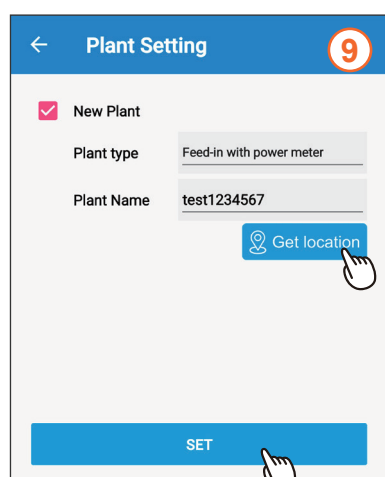

10. Fill in the e-mail address to assign the owner to the plant. (For more detail, please refer to "More Info.")

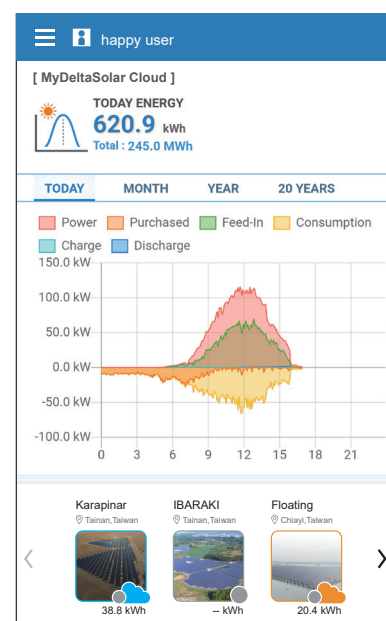
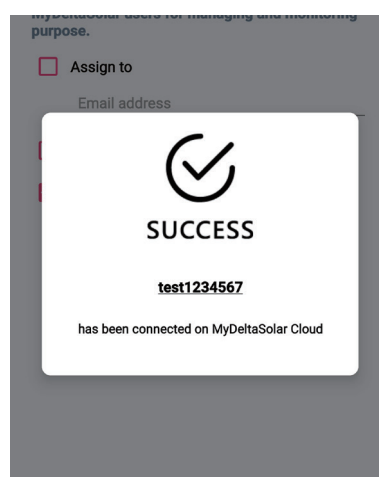
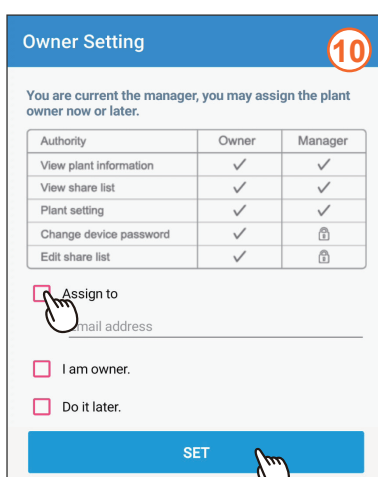

More Info.

Function accessibility list

Authority / Function	Owner	Manager	Viewer
View plant information	✓	✓	✓
View share list	✓	✓	✓
Plant setting	✓	✓	🔒
Change device password	✓	🔒	🔒
Edit share list	✓	🔒	🔒

Definition of Status Icon

On site connection	Cloud connection
no signal not connected monitoring	no Internet monitoring fault error/waring/disconnect